

DADO ESAGONALE

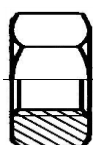

| D | Passo grosso | S | e min | ALTO m | kg~ per 1000 Pz | MEDIO m | kg~ per 1000 Pz | BASSO m | kg~ per 1000 Pz |
|------|-----------------|-----|-------|-----------|--------------------|------------|--------------------|------------|--------------------|
| M2 | 0,4 | 4 | 4,32 | 2 | 0,173 | 1,6 | 0,147 | 1 | |
| M2,5 | 0,45 | 5 | 5,45 | 2,5 | 0,327 | 2 | 0,278 | 1 | |
| M3 | 0,5 | 5,5 | 6,01 | 3 | 0,470 | 2,4 | 0,380 | 2 | 0,257 |
| M4 | 0,7 | 7 | 7,66 | 4 | 1,000 | 3,2 | 0,810 | 3 | 0,492 |
| M5 | 0,8 | 8 | 8,79 | 5 | 1,520 | 4 | 1,220 | 3,5 | 0,780 |
| M6 | 1 | 10 | 11,05 | 6 | 2,960 | 5 | 2,470 | 4 | 1,980 |
| M7 | 1 | 11 | 12,12 | 7 | 3,120 | 5,5 | 3,970 | 4 | 2,250 |
| M8 | 1,25 | 13 | 14,38 | 8 | 6,500 | 6,5 | 5,360 | 5 | 4,090 |
| M10 | 1,5 | 17 | 18,9 | 10 | 14,500 | 8 | 11,600 | 6 | 8,660 |
| M12 | 1,75 | 19 | 21,1 | 12 | 20,400 | 10 | 17,000 | 7 | 11,900 |
| M14 | 2 | 22 | 24,49 | 14 | 31,700 | 11 | 25,000 | 8 | 18,110 |
| M16 | 2 | 24 | 26,75 | 16 | 41,000 | 13 | 33,400 | 8 | 20,530 |
| M18 | 2,5 | 27 | 30,14 | 18 | 59,000 | 15 | 49,300 | 9 | 29,550 |
| M20 | 2,5 | 30 | 33,53 | 20 | 80,300 | 16 | 64,200 | 9 | 36,130 |
| M22 | 2,5 | 32 | 35,72 | 22 | 96,300 | 18 | 78,800 | 10 | 43,770 |
| M24 | 3 | 36 | 39,98 | 24 | 138,750 | 19 | 109,900 | 10 | 57,800 |
| M27 | 3 | 41 | 45,63 | 27 | 203,160 | 22 | 165,500 | 12 | 90,300 |
| M30 | 3,5 | 46 | 51,28 | 30 | 288,200 | 24 | 230,500 | 12 | 115,260 |
| M33 | 3,5 | 50 | 55,37 | 33 | 361,000 | 26 | 288,000 | 14 | 155,000 |
| M36 | 4 | 55 | 60,79 | 36 | 483,000 | 29 | 393,000 | 14 | 190,000 |
| M39 | 4 | 60 | 66,44 | 39 | 623,000 | 31 | 502,000 | 16 | 260,000 |
| M42 | 4,5 | 65 | 71,3 | 42 | 795,000 | 34 | 655,000 | 16 | 307,000 |
| M45 | 4,5 | 70 | 76,95 | 45 | 988,000 | 36 | 800,000 | 18 | 400,000 |
| M48 | 5 | 75 | 82,6 | 48 | 1220,000 | 38 | 980,000 | 18 | 460,000 |
| M52 | 5 | 80 | 88,25 | 52 | 1470,000 | 42 | 1220,000 | 20 | 580,000 |
| M56 | 5,5 | 85 | 93,56 | 56 | 1770,000 | 45 | 1420,000 | 22 | 709,000 |
| M60 | 5,5 | 90 | 95,21 | 60 | 2080,000 | 48 | 1690,000 | 24 | 780,000 |
| M64 | 6 | 95 | 105 | 64 | 2280,000 | 51 | 1820,000 | 26 | 930,000 |

