

RONDELLE TORNITE CONCAVE

DIN 6319 G

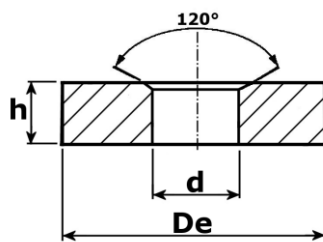

| Per bullone | d | De | h | Kg~ per 1000 Pz |
|-------------|------|-----|----|-----------------|
| M6 | 7,1 | 17 | 4 | 5,500 |
| M8 | 9,6 | 23 | 4 | 13,000 |
| M10 | 12 | 28 | 5 | 19,000 |
| M12 | 14,2 | 35 | 5 | 32,000 |
| M14 | 16,5 | 40 | 5 | 48,000 |
| M16 | 19 | 45 | 6 | 56,000 |
| M20 | 23,2 | 50 | 8 | 94,000 |
| M24 | 28 | 60 | 10 | 169,000 |
| M30 | 35 | 68 | 10 | 218,000 |
| M36 | 42 | 80 | 12 | 350,000 |
| M42 | 49 | 100 | 15 | 640,000 |
| M48 | 56 | 110 | 17 | 830,000 |