

## RONDELLE TORNITE CONCAVE

DIN 6319 D

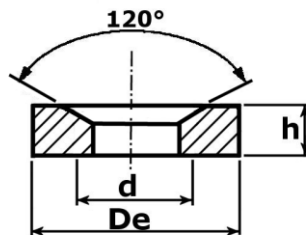

Per bullone	d	De	h	Kg- per 1000 Pz
<b>M6</b>	7,1	12	2,8	1,500
<b>M8</b>	9,6	17	3,5	4,000
<b>M10</b>	12	21	4,2	6,500
<b>M12</b>	14,2	24	5	10,000
<b>M14</b>	16,5	28	5,6	18,000
<b>M16</b>	19	30	6,2	19,000
<b>M20</b>	23,2	36	7,5	32,000
<b>M24</b>	28	44	9,5	63,000
<b>M30</b>	35	56	12	133,000
<b>M36</b>	42	68	15	236,000
<b>M42</b>	49	78	18	365,000
<b>M48</b>	56	92	22	641,000