

VITI TESTA TONDA CON QUADRO SOTTOTESTA

UNI 5731 – DIN 603 – ISO 8677

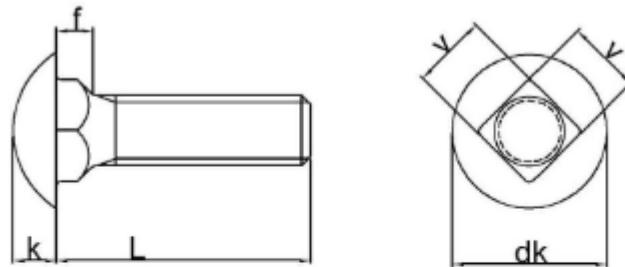

Size	dk		k		f		v	
	min	max	min	max	min	max	min	max
M5	12.45	13.55	2.7	3.3	2.9	4.1	4.52	5.48
M6	15.45	16.55	3.12	3.88	3.4	4.6	5.52	6.48
M8	19.35	20.65	4.12	4.88	4.4	5.6	7.42	8.58
M10	23.35	24.65	4.62	5.38	5.4	6.6	9.42	10.58
M12	29.35	30.65	6.05	6.95	7.25	8.75	11.3	12.7
M16	37.2	38.8	8.05	8.95	11.1	12.9	15.3	16.7
M20	45.2	46.8	9.95	11.05	14.1	15.9	19.16	20.84